

WLS LIGHTING SYSTEMS

LHW SEMI-CUTOFF LED HOODED WALL PACK SERIES

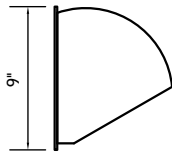

DIMENSIONS

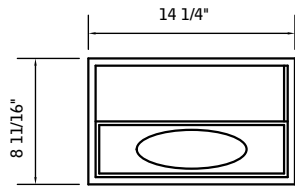

CSA Certified
listed for wet locations

SPECIFICATIONS

HOUSING - The LHW is made from a die-cast aluminum housing and hinged door frame. Featuring 1/2" coin plugs with o-rings for conduit and a textured architectural bronze powdercoat finish over a chromate conversion coating. Custom colors available on request.

LENS - Tempered clear flat glass.

REFLECTOR - None.

LIGHT SOURCES - LED module included with a 24 watt, 18 LED's at 1800 lumens or 48 watt, 18 LED's at 3600 lumens.

MOUNTING - Cast-in template for mounting directly over a 4" recessed outlet box, or use 1/2" surface conduit.

WARRANTY - 1 year manufacturers warranty.

ORDERING INFORMATION SELECT APPROPRIATE CHOICE FROM EACH COLUMN TO FORMULATE ORDER CODE. Refer to example below.

SERIES	LAMP WATTAGE	LIGHT SOURCE	LINE VOLTAGE	LUMINAIRE FINISH	OPTIONS
LHW	24 48	LED	120V 277V	BRZ - Bronze CC - Custom Color	NO - No Options

LHW

24

LED

120

BRZ

NO

(EXAMPLE ORDER)

ORDER :

WLS-LHW

LED

Approved By: _____ Project Name: _____

Location: _____ Date: _____

P.O. Box 100519 | Fort Worth, TX 76185 | 800.633.8711 | Fax: 817.735.4824 | www.wslighting.com

WLS LIGHTING SYSTEMS

Consider the Impact!