

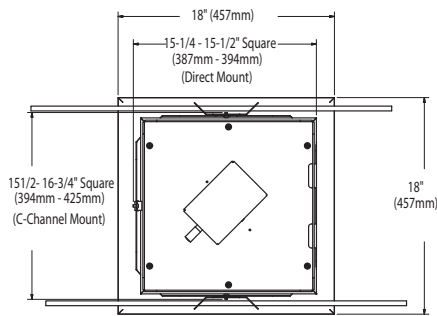

## DIMENSIONS

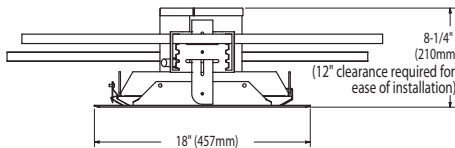

TOP VIEW



SIDEVIEW  
(Channel Mount Shown)

SHIPPING WEIGHT - 14 lbs. (6.4kg)

IP67



Intertek  
Suitable for wet locations

RoHS  
COMPLIANT



## SPECIFICATIONS

**HOUSING / OPTICAL UNIT** - Housing is die-formed aluminum with a gasketed clear tempered glass lens providing a water-resistant seal. Weather-tight aluminum enclosure contains factory prewired driver to ensure no water entry. Sealed optical unit containing LEDs rated IP67.

**EXPECTED LIFE** - Minimum 60,000 hours to 100,000 hours depending upon the ambient temperature of the installation location.

**LEDS** - Select high-brightness LEDs. 5750°K color temperature (nominal).

**DISTRIBUTION / PERFORMANCE** - Type S. Excellent uniformity with full cutoff.

**ELECTRICAL** - Universal frequency power supply (50 / 60 Hz). Supply voltage must be specified for pre-wired thermal protectors.

**DRIVER** - State-of-the-art driver technology designed specifically for WLS LED light sources provides unsurpassed system efficiency. Driver will operate with input of 120V thru 277V (50 / 60Hz). Components are fully encased in potting material for moisture resistance. Driver complies with IEC and FCC standards.

**OPERATING TEMPERATURE** - -40°C to +50°C (-40°F to +122°F).

**FINISH** - Fixtures are finished with WLS's DuraGrip® polyester powder coat finishing process. The DuraGrip finish withstands extreme weather changes without cracking or peeling, and is guaranteed for five full years. Standard color is white.

**MOUNTING** - Direct Mounts with screws through the trim frame (standard). Optional channel bar kit available to suspend assembly from ceiling joists.

**WARRANTY** - WLS LED fixtures carry a limited 5-year warranty.

**LISTING** - Listed to U.S. and Canadian safety standards. Suitable for wet locations.

Approved By: \_\_\_\_\_ Project Name: \_\_\_\_\_

Location: \_\_\_\_\_ Date: \_\_\_\_\_

# SLL LED SOFFIT LIGHT SERIES

**ORDERING INFORMATION** SELECT APPROPRIATE CHOICE FROM EACH COLUMN TO FORMULATE ORDER CODE. Refer to example below.

SERIES	DISTRIBUTION	# OF LEDs	LIGHT SOURCE	LED COLOR TEMPERATURE	LENS	VOLTAGE	LUMINAIRE FINISH	OPTIONS
SLL	S - Symmetrical	50	LED	CW - Cool White (5750°K nom.)	FG - Flat Clear Tempered Glass	120V 208V 240V 277V	WHT - White	CMT - Channel Bar Mounting Kit DM - Direct Mount NO - No Options

**SLL S 50 LED CW FG 120 WHT NO**

(EXAMPLE ORDER)

**ORDER:**  
**WLS-SLL** \_\_\_\_\_

Approved By: \_\_\_\_\_ Project Name: \_\_\_\_\_

Location: \_\_\_\_\_ Date: \_\_\_\_\_

P.O. Box 100519 | Fort Worth, TX 76185 | 800.633.8711 | Fax: 817.735.4824 | [www.wslighting.com](http://www.wslighting.com)

**WLS** LIGHTING SYSTEMS

Consider the Impact!

01 Rev. 7/10